

958 Nostrand Avenue

Between Montgomery Street & Sullivan Place
Brooklyn, NY 11225

HELLER

ORGANIZATION



SIZE: **Space A:** Approximately 3,536 SF - Ground Floor
Approximately 1,329 SF - Basement

Space B: Approximately 1,980 SF - Ground Floor

RENT: Upon Request

POSSESSION: Immediate

COMMENTS: -Over 200' of frontage on Nostrand Avenue
-New construction, with multiple divisions possible
-All uses considered

NEIGHBORS:

- Associated Supermarkets
- Chase Bank
- Dunkin' Donuts
- Subway
- T-Mobile
- Golden Krust
- Mother's Care Day Care
- Body Basix Fitness
- PS 161
- Medgar Evers School

Joshua Singer
josh@hellerorg.com

Stephen Weber
stephen@hellerorg.com

917.332.7530

54 West 21st Street, 608 | New York, NY 10010 | O: 212 366-5034 | E: retail@hellerorg.com

All information is from sources deemed reliable. No representation is made and we do not guarantee the accuracy of any information provided. All information must be independently verified. The value of any real estate investment is dependant on a variety of factors and should be evaluated carefully by prospective purchasers and/or tenants.

THE OWNER AGREES THAT THIS AND ANY OTHER ARCHITECTURAL OR ENGINEERING DRAWINGS, SPECIFICATIONS, CONTRACTS, AGREEMENTS, AND CORRECTIONS, AND ANY OTHER DOCUMENTS, SHALL BE THE PROPERTY OF THE ARCHITECT AND ENGINEER AND SHALL BE KEPT IN CONFIDENCE AND NOT REPRODUCED OR TRANSMITTED IN ANY FORM OR BY ANY MEANS, ELECTRONIC OR MECHANICAL, INCLUDING PHOTOCOPYING, RECORDING, OR BY ANY INFORMATION STORAGE AND RETRIEVAL SYSTEM, WITHOUT THE WRITTEN PERMISSION OF THE ARCHITECT AND ENGINEER.



REVISIONS	
NO.	DESCRIPTION
01	ISSUED FOR CONSTRUCTION
02	MAIL ROOM
03	REC. ROOM
04	REVISIONS TO ALL DRAWINGS
05	REVISIONS TO ALL DRAWINGS
06	REVISIONS TO ALL DRAWINGS
07	REVISIONS TO ALL DRAWINGS
08	REVISIONS TO ALL DRAWINGS
09	REVISIONS TO ALL DRAWINGS
10	REVISIONS TO ALL DRAWINGS
11	REVISIONS TO ALL DRAWINGS
12	REVISIONS TO ALL DRAWINGS
13	REVISIONS TO ALL DRAWINGS
14	REVISIONS TO ALL DRAWINGS
15	REVISIONS TO ALL DRAWINGS
16	REVISIONS TO ALL DRAWINGS
17	REVISIONS TO ALL DRAWINGS
18	REVISIONS TO ALL DRAWINGS
19	REVISIONS TO ALL DRAWINGS
20	REVISIONS TO ALL DRAWINGS
21	REVISIONS TO ALL DRAWINGS
22	REVISIONS TO ALL DRAWINGS
23	REVISIONS TO ALL DRAWINGS
24	REVISIONS TO ALL DRAWINGS
25	REVISIONS TO ALL DRAWINGS
26	REVISIONS TO ALL DRAWINGS
27	REVISIONS TO ALL DRAWINGS
28	REVISIONS TO ALL DRAWINGS
29	REVISIONS TO ALL DRAWINGS
30	REVISIONS TO ALL DRAWINGS
31	REVISIONS TO ALL DRAWINGS
32	REVISIONS TO ALL DRAWINGS
33	REVISIONS TO ALL DRAWINGS
34	REVISIONS TO ALL DRAWINGS
35	REVISIONS TO ALL DRAWINGS
36	REVISIONS TO ALL DRAWINGS
37	REVISIONS TO ALL DRAWINGS
38	REVISIONS TO ALL DRAWINGS
39	REVISIONS TO ALL DRAWINGS
40	REVISIONS TO ALL DRAWINGS
41	REVISIONS TO ALL DRAWINGS
42	REVISIONS TO ALL DRAWINGS
43	REVISIONS TO ALL DRAWINGS
44	REVISIONS TO ALL DRAWINGS
45	REVISIONS TO ALL DRAWINGS
46	REVISIONS TO ALL DRAWINGS
47	REVISIONS TO ALL DRAWINGS
48	REVISIONS TO ALL DRAWINGS
49	REVISIONS TO ALL DRAWINGS
50	REVISIONS TO ALL DRAWINGS

KARL FISCHER ARCHITECT
 1000 10th Avenue, Suite 1000
 New York, NY 10018
 Tel: 212-692-1000
 Fax: 212-692-1001
 www.kfarchitect.com

Shawmut Engineering PLLC
 1000 10th Avenue, Suite 1000
 New York, NY 10018
 Tel: 212-692-1000
 Fax: 212-692-1001
 www.shawmut.com

WEXLER & ASSOCIATES
 1000 10th Avenue, Suite 1000
 New York, NY 10018
 Tel: 212-692-1000
 Fax: 212-692-1001
 www.wexler.com

RESIDENTIAL DEVELOPMENT
 305 SULLIVAN PLACE
 1000 10th Avenue, Suite 1000
 New York, NY 10018
 Tel: 212-692-1000
 Fax: 212-692-1001
 www.residentialdevelopment.com

SPACED ROOM PLAN
 ALTERNATE RED SPACE

DATE	1/18/2017	SHEET NO.	07-10
SCALE	1/8" = 1'-0"	PROJECT NO.	11
DESIGNER	WEXLER	DATE	1/18/2017
CHECKER	WEXLER	PROJECT	A-102
DATE	1/18/2017	SCALE	1/8" = 1'-0"

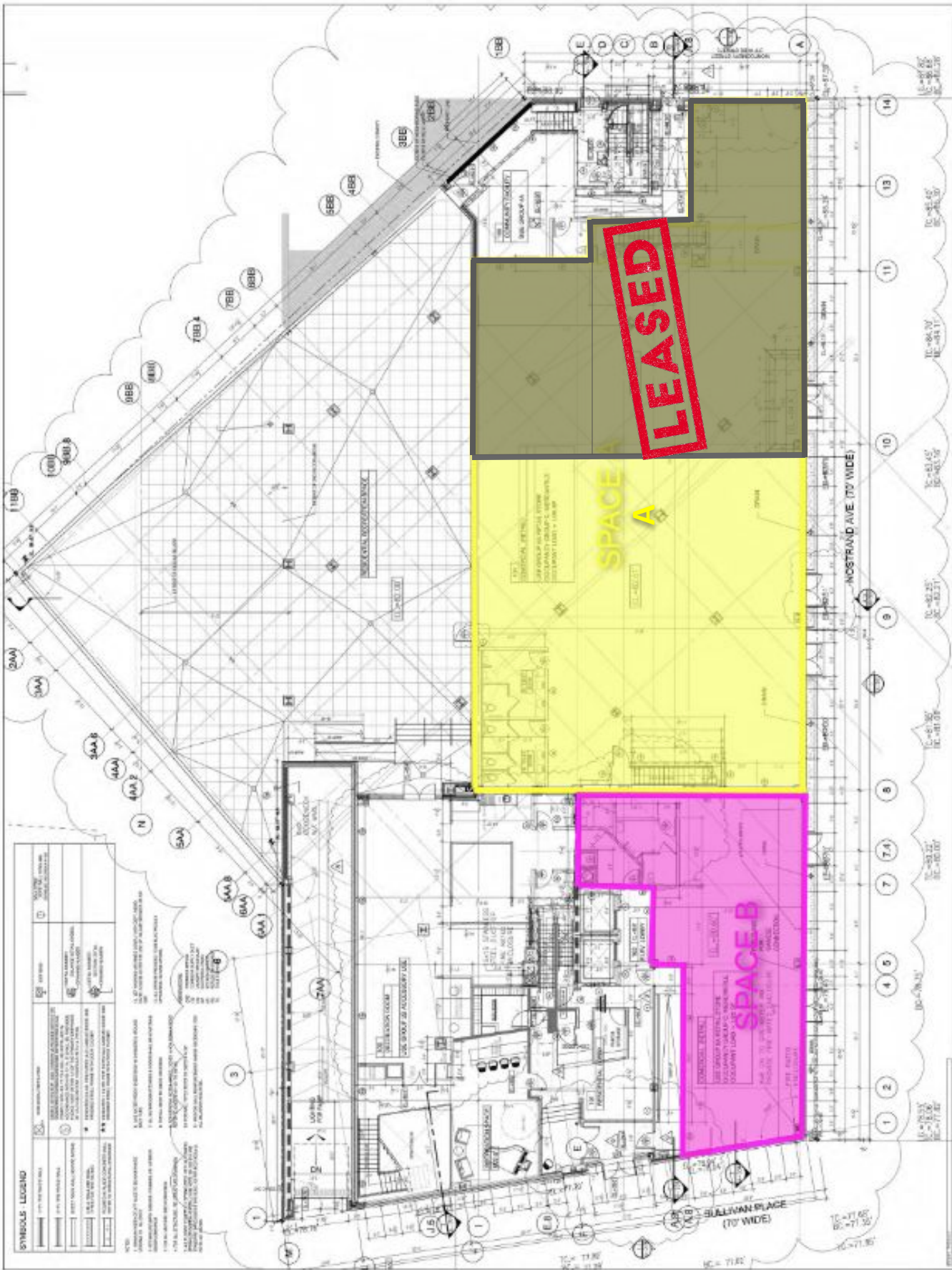

SYMBOLS LEGEND

1	1/8" = 1'-0"	1/8" = 1'-0"
2	1/8" = 1'-0"	1/8" = 1'-0"
3	1/8" = 1'-0"	1/8" = 1'-0"
4	1/8" = 1'-0"	1/8" = 1'-0"
5	1/8" = 1'-0"	1/8" = 1'-0"
6	1/8" = 1'-0"	1/8" = 1'-0"
7	1/8" = 1'-0"	1/8" = 1'-0"
8	1/8" = 1'-0"	1/8" = 1'-0"
9	1/8" = 1'-0"	1/8" = 1'-0"
10	1/8" = 1'-0"	1/8" = 1'-0"
11	1/8" = 1'-0"	1/8" = 1'-0"
12	1/8" = 1'-0"	1/8" = 1'-0"
13	1/8" = 1'-0"	1/8" = 1'-0"
14	1/8" = 1'-0"	1/8" = 1'-0"
15	1/8" = 1'-0"	1/8" = 1'-0"
16	1/8" = 1'-0"	1/8" = 1'-0"
17	1/8" = 1'-0"	1/8" = 1'-0"
18	1/8" = 1'-0"	1/8" = 1'-0"
19	1/8" = 1'-0"	1/8" = 1'-0"
20	1/8" = 1'-0"	1/8" = 1'-0"
21	1/8" = 1'-0"	1/8" = 1'-0"
22	1/8" = 1'-0"	1/8" = 1'-0"
23	1/8" = 1'-0"	1/8" = 1'-0"
24	1/8" = 1'-0"	1/8" = 1'-0"
25	1/8" = 1'-0"	1/8" = 1'-0"
26	1/8" = 1'-0"	1/8" = 1'-0"
27	1/8" = 1'-0"	1/8" = 1'-0"
28	1/8" = 1'-0"	1/8" = 1'-0"
29	1/8" = 1'-0"	1/8" = 1'-0"
30	1/8" = 1'-0"	1/8" = 1'-0"
31	1/8" = 1'-0"	1/8" = 1'-0"
32	1/8" = 1'-0"	1/8" = 1'-0"
33	1/8" = 1'-0"	1/8" = 1'-0"
34	1/8" = 1'-0"	1/8" = 1'-0"
35	1/8" = 1'-0"	1/8" = 1'-0"
36	1/8" = 1'-0"	1/8" = 1'-0"
37	1/8" = 1'-0"	1/8" = 1'-0"
38	1/8" = 1'-0"	1/8" = 1'-0"
39	1/8" = 1'-0"	1/8" = 1'-0"
40	1/8" = 1'-0"	1/8" = 1'-0"
41	1/8" = 1'-0"	1/8" = 1'-0"
42	1/8" = 1'-0"	1/8" = 1'-0"
43	1/8" = 1'-0"	1/8" = 1'-0"
44	1/8" = 1'-0"	1/8" = 1'-0"
45	1/8" = 1'-0"	1/8" = 1'-0"
46	1/8" = 1'-0"	1/8" = 1'-0"
47	1/8" = 1'-0"	1/8" = 1'-0"
48	1/8" = 1'-0"	1/8" = 1'-0"
49	1/8" = 1'-0"	1/8" = 1'-0"
50	1/8" = 1'-0"	1/8" = 1'-0"